



Lewisham

LAND TO THE EAST SIDE OF 68 RAVENSBOURNE PARK CRESCENT SE6 4YP

Application Ref. DC/24/135333

Construction of 5 two-storey dwellinghouses, together with cycle parking, refuse storage and associated landscaping on Land to the East of 68 Ravensbourne Park Crescent SE6.

Existing site

Site location



Existing site conditions



East



West



North

Street view



Proposal

Proposed site plan

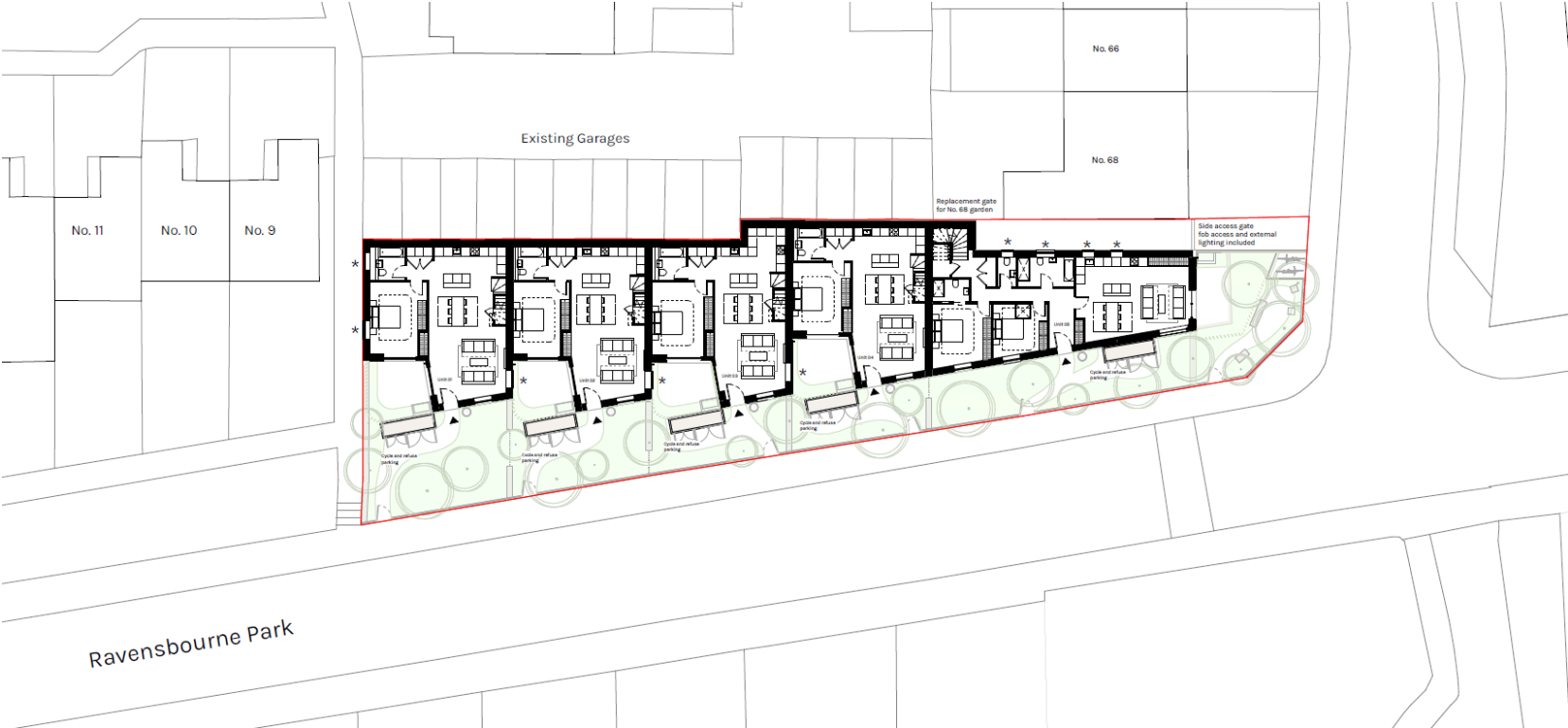

Illustration of development from south-east



Illustration of development from north-east



Main planning considerations

Main planning considerations

- Principle of development
- Housing
- Urban design and impact on heritage assets
- Impact on adjoining properties
- Transport
- Sustainability
- Natural environment
- Public health, wellbeing and safety

End